

JEEP JL ADJ FR LOWER CONTROL ARMS

Thank you for choosing Rough Country for your suspension needs.

In addition to these instructions, professional knowledge of disassemble/reassembly procedures as well as post installation checks must be known. Attempts to install this system without this knowledge and expertise may jeopardize the integrity and/or operating safety of the vehicle.

PRODUCT USE INFORMATION

Rough Country makes no claims regarding lifting devices and excludes any and all implied claims. We will not be responsible for any product that is altered.

If question exist we will be happy to answer any questions concerning the design, function, and correct use of our products by calling 1-800-222-7023.

NOTICE TO DEALER AND VEHICLE OWNER

Any vehicle equipped with any Rough Country product should have a "Warning to Driver" decal installed on the inside of the windshield or on the vehicle's dash. The decal should act as a constant reminder for whoever is operating the vehicle of its unique handling characteristics. INSTALLING DEALER - it is your responsibility to install the warning decal and forward these installation instructions on to the vehicle owner for review. These instructions should be kept in the vehicle for its service

Kit Contents:
2-X-flex Joints
2-Arms



Tools Needed:
15mm Wrench
19mm Deep Well Socket
21mm Wrench
24mm Wrench
Jack
Jack Stand



FRONT INSTALLATION INSTRUCTIONS

1. Place vehicle in park and chock the rear wheels. Raise the front of the vehicle with a jack and secure a jack stand beneath each frame rail behind the front control arms. Ease the frame down onto the stands.
2. Remove the front tires/wheels, using a 19mm deep well socket.
3. Remove the brake line bracket from the lower control arm using a 15mm wrench.
4. Remove the lower control arms using 21mm and 24mm wrenches. Retain hardware for reuse. **See Photo 1.**
5. Install the adjustable lower control arm on the axle using the factory hardware. **Do not tighten at this time. See Photo 2.**

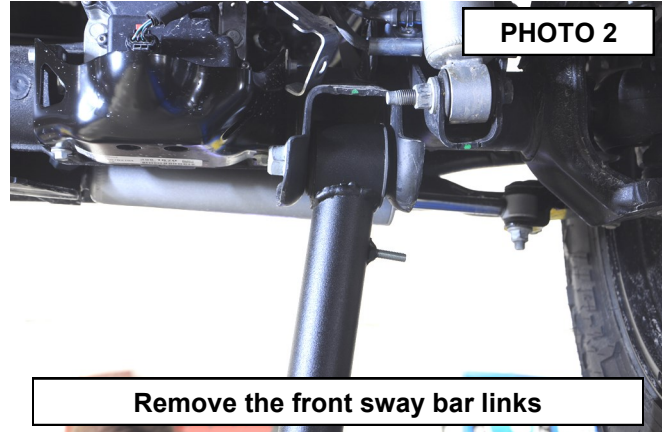
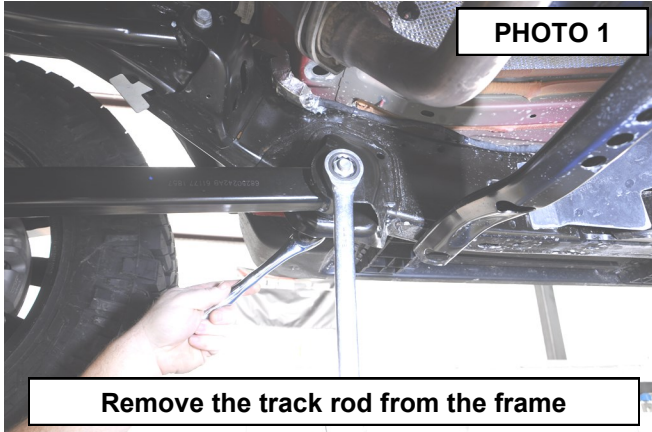

6. Install the flex joint end in the control arm pocket on the frame, using the factory hardware. **Do not tighten at this time. See Photo 3.**
7. Install the brake line bracket on the lower control arm using the factory hardware. Tighten using a 15mm wrench. **See Photo 4.**
8. Reinstall the wheels and tires and lower the vehicle to the ground. Torque all arm hardware to factory specs. **Note** Make sure flex joint housing is centered in mount before tightening jam nut. Should not be touching either side.****

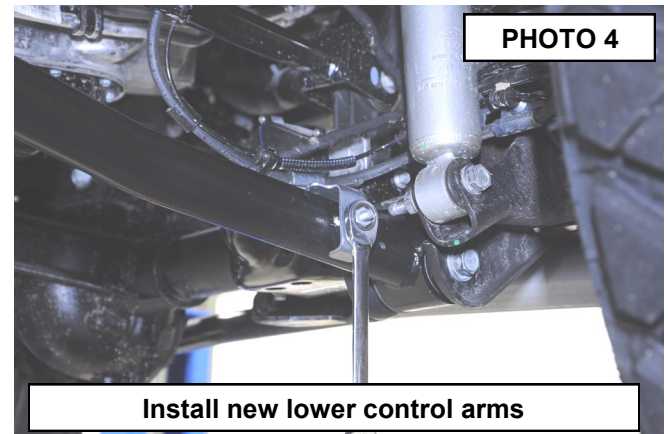
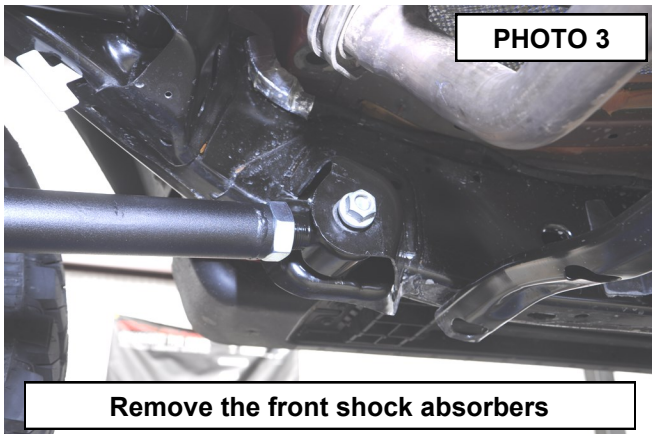

POST INSTALLATION

- Check all fasteners for proper torque.
- Re-torque all fasteners after 500 miles and recheck after 1000 miles.
- Have a qualified alignment center realign the front end.

By purchasing any item sold by Rough Country, LLC, the buyer expressly warrants that he/she is in compliance with all applicable , State, and Local laws and regulations regarding the purchase, ownership, and use of the item. It shall be the buyers responsibility to comply with all Federal, State and Local laws governing the sales of any items listed, illustrated or sold. The buyer expressly agrees to indemnify and hold harmless Rough Country, LLC for all claims resulting directly or indirectly from the purchase, ownership, or use of the items.

